

NORTH SIDE OF COMPLEX

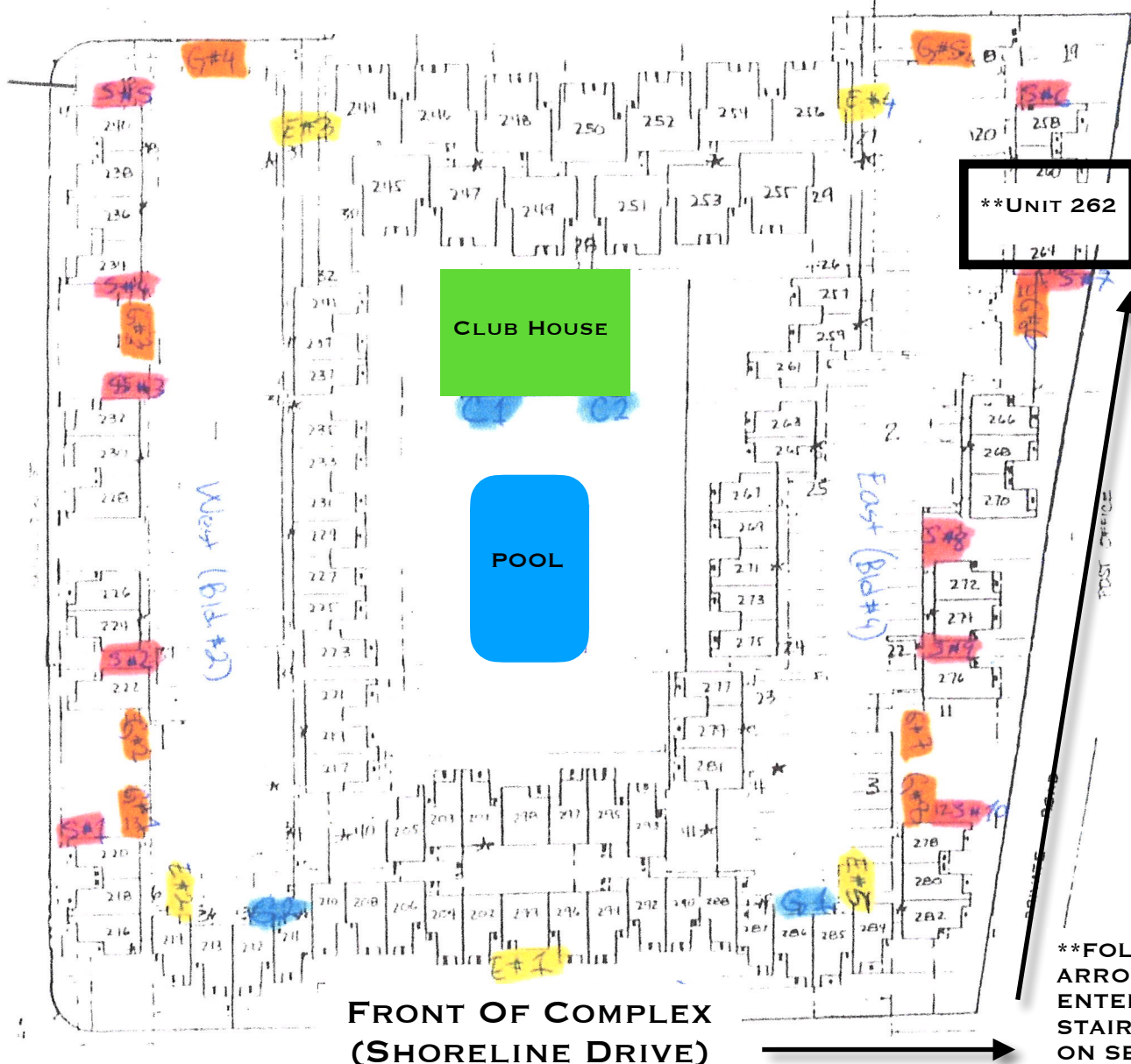

\*\*FOLLOW ARROWS. ENTER AT STAIRCASE ON SECOND LEVEL. LOCKBOX ON RAIL.

5 MAIN ENTRANCES

10 SIDE ENTRANCES (#2, 4, 7, and #9 have electric strikes)

2 CLUBHOUSE and 2 GYM ENTRANCES

8 GARAGE ENTRANCES

2101 SHORELINE DRIVE - UNIT 262  
 HOA GROUNDS MAP  
 DIRECTIONS TO UNIT

**COMPASS**

Michele Senitzer  
 Real Estate Group